



RECREATIONAL  
VEHICLES

# SPORTSMEN CLASSIC

ULTRA LIGHTWEIGHT TRAVEL TRAILERS



181BH | Ashwood décor



SOLAR  
PREP



**BENCH-SEAT DINETTE** big enough for family meals, then folds down neatly for comfortable sleep space.



TONGUE & GROOVE  
PLYWOOD FLOORING



includes 15-inch mud tires with aluminum rims, extra ground clearance, an electronically-controlled heated holding tank, and double entry step.

Ultra Lightweight Travel Trailers	100RK	100SB	130RB	160QB	160RBT	170MB	180BH	180RBT	180TH	181BH	190BH	190TH	191BHK
UVW (Unloaded Vehicle Weight)*	1,770	1,780	2,190	2,850	2,790	2,910	2,600	3,290	3,260	3,020	3,260	3,430	TBD
Dry Hitch Weight*	220	220	290	370	310	460	260	390	460	370	360	470	TBD
Dry Axle Weight*	1,550	1,560	1,900	2,480	2,480	2,450	2,340	2,900	2,800	2,650	2,900	2,960	TBD
CCC (Cargo Carrying Capacity)	1,030	1,020	610	650	710	590	900	1,210	1,740	480	1,740	1,570	TBD
GVWR	2,800	2,800	2,800	3,500	3,500	3,500	3,500	4,500	5,000	3,500	5,000	5,000	TBD
Interior Height	78"	78"	78"	78"	78"	78"	78"	78"	78"	78"	78"	78"	78"
Exterior Height w/o A/C (unless noted)**	107"	107"	107"	107"	107"	112"	107"	118***	107"	112"	112"	112"	112"
Exterior Width	84"	84"	84"	90"	90"	90"	84"	90"	90"	84"	90"	90"	90"
Exterior Length***	13' 2"	13' 2"	16' 3"	22'	19' 2"	22'	20' 11"	21' 9"	21' 8"	20' 11"	23' 3"	22' 6"	22' 1"
Refrigerator (cu. feet)	3	3	3	8	8	8	8	8	8	8	8	8	8
Water Heater Cap. (gal. LP w/DSI)	6	6	6	6	6	6	6	6	6	6	6	6	6
Fresh Water Cap. (gal.)	20	20	20	20	20	20	20	20	38	20	20	38	20
Waste Water Cap. (gal.)	N/A	N/A	15	32	24	26	15	24	30	15	30	30	26
Gray Water Cap. (gal.)	26	26	15	32	32	32	15	32	30	15	30	30	32
LP Gas Cap. (lbs.)	20	20	20	20	20	20	20	20	20	20	20	20	20
Furnace BTUs (1,000s)	20	20	20	20	20	20	20	20	20	20	20	20	20
Tire Size	14"	14"	14"	14"	14"	14"	14"	14"	15"	14"	14"	14"	14"
Awning	N/A	N/A	9'	10'	12'	12'	9'	13'	13'	14'	14'	14'	14'

\*This weight reflects the rolling average unit weight for each model. Your trailer weight will vary according to optional equipment. \*\*This exterior height is with A/C. \*\*\* Exterior length is measured from rear of bumper to leading edge of coupler.

# 2021 SPORTSMEN CLASSIC TRAVEL TRAILERS

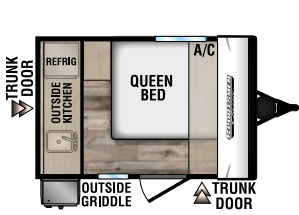

**100RK**  
UWV - 1,770 | Exterior Length - 13' 2" | Sleeps 2

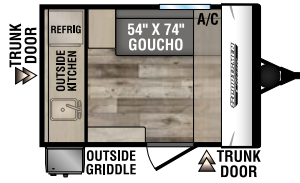

**100SB**  
UWV - 1,780 | Exterior Length - 13' 2" | Sleeps 2

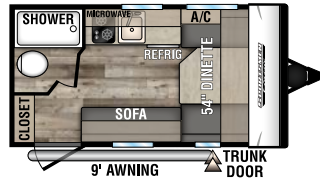

**130RB**  
UWV - 2,190 | Exterior Length - 16' 3" | Sleeps 2

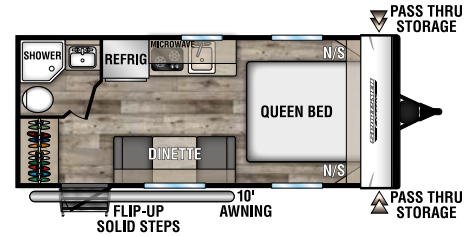

**160QB**  
UWV - 2,850 | Exterior Length - 22' | Sleeps 3

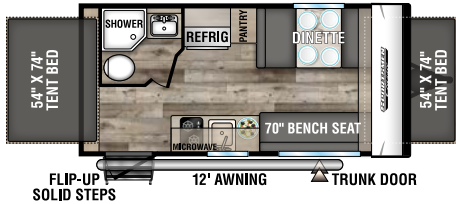

**160RB**  
UWV - 2,790 | Exterior Length - 18' 2" | Sleeps 6

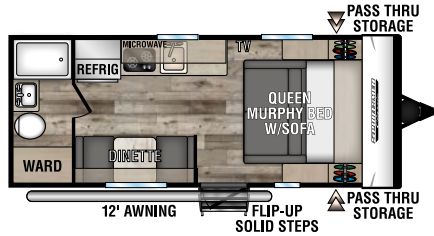

**170MB**  
UWV - 2,910 | Exterior Length - 22' | Sleeps 3

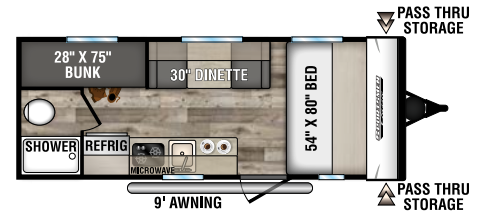

**180BH**  
UWV - 2,600 | Exterior Length - 20' 11" | Sleeps 4

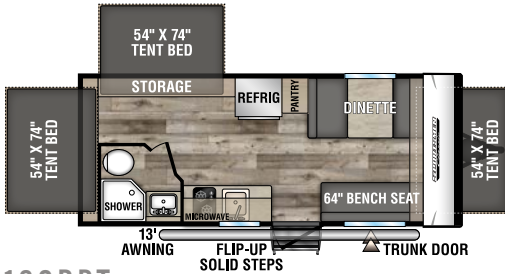

**180RB**  
UWV - 3,290 | Exterior Length - 21' 9" | Sleeps 8

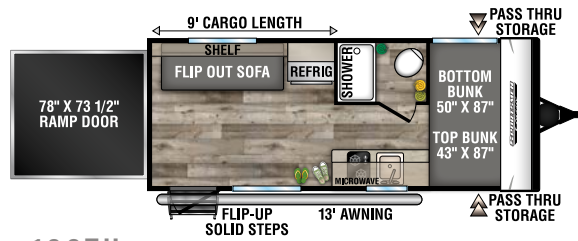

**180TH TOY HAULER**  
UWV - 3,260 | Exterior Length - 21' 8" | Sleeps 4

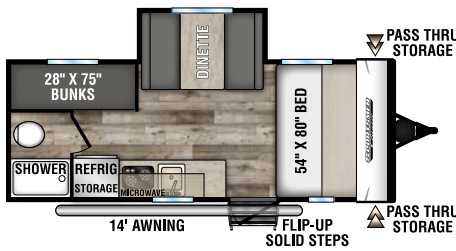

**181BH**  
UWV - 3,020 | Exterior Length - 20' 11" | Sleeps 5

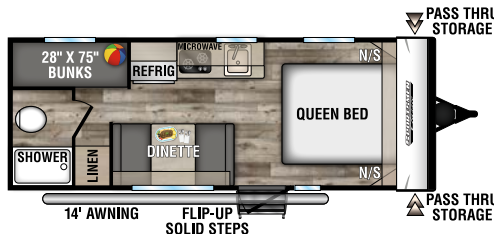

**190BH**  
UWV - 3,260 | Exterior Length - 23' 3" | Sleeps 5

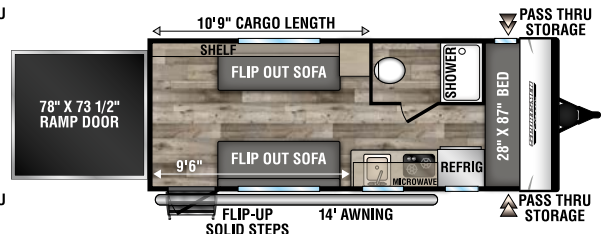

**190TH TOY HAULER**  
UWV - 3,430 | Exterior Length - 22' 6" | Sleeps 3

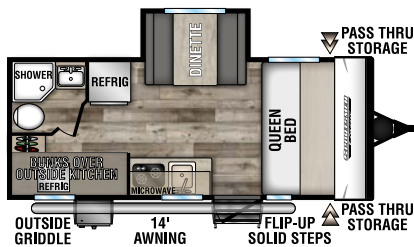

**191BHK** **NEW**  
UWV - TBD | Exterior Length - 22' 1" | Sleeps 5



Dealer: \_\_\_\_\_



985 N 900 W SHIP SHEWANA, IN 46565

E: KZ@KZ-RV.COM

WWW.KZ-RV.COM

Due to continual research and advances, manufacturer reserves the right to change specifications, design, price and equipment without notice, and assumes no responsibility for any error in this literature. Some items shown are not included as standard or optional equipment.

©2020KZ | 09/15/20 | 20M